

# MOL 200 Oil Burner



## MOL 200 Oil Burner features:

- Energy saving and compatible with environmental requirements
- Quiet in operation and designed for easy maintenance
- Reliable and trouble-free
- Designed and approved in accordance with the European Standard EN 267
- Suitable for high resistance boilers
- Industry standard components easily available
- Designed for on/off and high/low operation
- Plug-in contact facilitates the installation
- With hydraulic air adjustment
- Fuel – Light distillate oil Class D (1.5-5.5 cSt @ 40°C)
- All kW ratings are nett CV



For more information on all Nu-way products  
please visit [www.nu-way.co.uk](http://www.nu-way.co.uk)

  
**Enertech Group**

Type		MOL 200 S1L	MOL 200 T1L
Capacity	kW	71 – 202	53-178
Motor	V/Hz	230/50	230/50
	W / A (Fuse)	180 / 10	180 / 10
Start / Run Current	Amps	6.5 / 1.85	6.5 / 1.85
Control box		Landis & Staefa	Landis & Staefa
Fuel pump		Danfoss / Suntec	Danfoss / Suntec
2-Stage			•
Gross weight	kg	18	18
Volume	m <sup>3</sup>	0.08	0.08

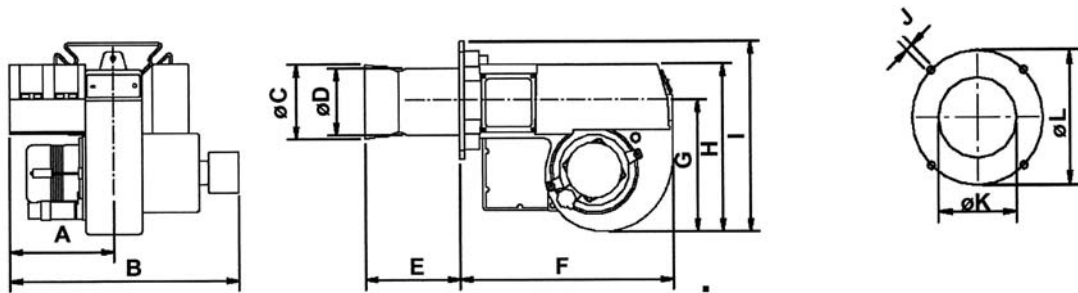
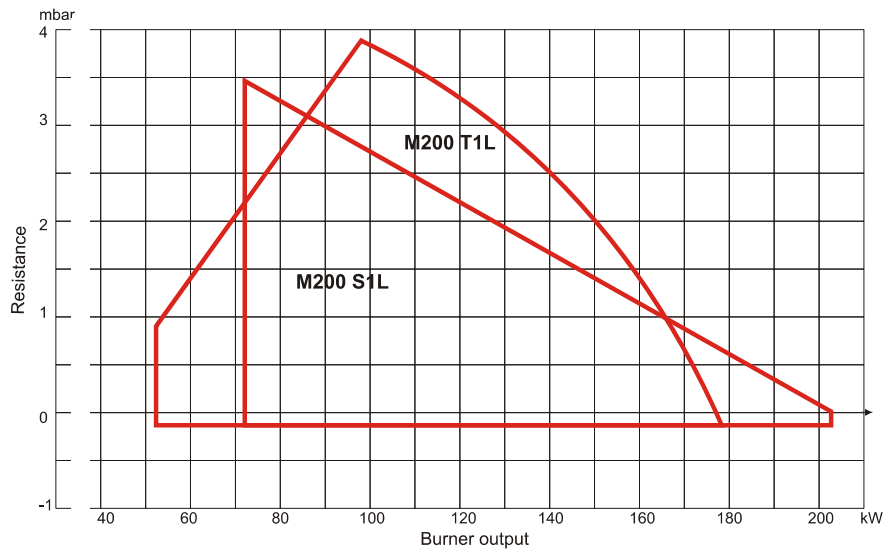

Burner	A	B	øC	øD	E*	F	G	H	I	J	øK	L
MOL 200 S1L	175	382	108	108	187	372	220	281	303	M10	115	160-190
MOL 200 T1L	188	415	110	110	174	372	220	281	303	M10	115	160-190

\* Extended Lengths Available

Enertech Limited, P O Box 1, Vines Lane  
Droitwich, Worcestershire, WR9 8NA

tel: +44 (0) 1905 794331 • fax: +44 (0) 1905 794017  
email: info@nu-way.co.uk • web: www.nu-way.co.uk

